

**16<sup>th</sup> NORTH AMERICAN AGROFORESTRY CONFERENCE**  
**GENERAL SCHEDULE**

**MONDAY, JUNE 24**

12:00-4:00pm	Pre-Conference Field Tour	Richardson Hall (Depart)
4:00-6:30pm	Registration Open	Richardson Hall, 1 <sup>st</sup> Floor
5:00-6:30pm	Welcome Reception	Richardson Hall, 1 <sup>st</sup> Floor
6:30pm	Dinner on Your Own	Downtown Corvallis

**TUESDAY, JUNE 25**

7:00-9:00am	Breakfast on Your Own Registration	Registration at Hilton Garden Inn
8:00am	Vans Depart for Tour 1: Oak Basin Farm & Aprovecho Sustainability Education Center	Hilton Garden Inn
9:00am	Bus Departs for Tour 2: USDA Germplasm Repository & Kenagy Family Farm	Hilton Garden Inn
12:00pm	Boxed Lunch	
5:00pm	Tyee Wine Cellars (Tour and Dinner)	Tyee Wine Cellars

**WEDNESDAY, JUNE 26**

7:30-8:30am	Breakfast and Registration Poster Setup (open all day)	CH2M Hill Alumni Center			
8:30-8:45am	Welcome Badege Bishaw, <i>Program Chair</i> Katy Kavanagh, <i>Associate Dean for Research, OSU College of Forestry</i>	Cascade Ballroom			
8:45-9:30am	Keynote: "Merging Conservation and Commerce – A Collective Impact Approach" Katie Commender, <i>Agroforestry Program Director, Appalachian Sustainable Development</i>	Cascade Ballroom			
9:30-9:45am	Coffee Break	Foyer			
9:45-10:45am	<b>Concurrent Session 1</b>				
	<b>Track</b>	<b>Speaker 1 – 9:45-10:05</b>	<b>Speaker 2 – 10:05-10:25</b>	<b>Speaker 3 – 10:25-10:45</b>	<b>Room</b>
	<i>Accessing Resources, Accessing Markets, and Managing Risk</i>	Panel Discussion <a href="#">Title: USDA Resources for Implementation</a> Lauren Cartwright, Heather Tritt, Donna Sprenkle, Susan Stein, and Timothy O'Connell Moderated by Matthew Smith			Willamette Room 115

<i>Advances in Technology Applications</i>	Roundtable Discussion <a href="#">Title: Bio-Regional Agroforestry Suitability Analysis: Using GIS to assess, inventory, and locate the appropriate implementation of tree crops and agroforestry systems</a> Russell Wallack			Trysting Tree Room 114
<i>Environmental Benefits</i>	Panel Discussion <a href="#">Title: Supporting Pacific Northwest Agriculture with Beneficial Insects and Agroforestry</a> Mace Vaughan, Gary Bentrup, and Bart Lawrence			Elle/Burlingham Room 111
<i>Specialty Forest Products</i>	Facilitated Discussion <a href="#">Title: The future of forest farming: What is it and who will do it?</a> Eric Burkhart and John Munsell			Cascade Ballroom
<i>Climate Change</i>	Panel Discussion <a href="#">Title: Evidence based Agroforestry Approaches for Enhancing Climate Smart Agricultural Production and Resilient Ecosystems</a> Kiros Hadgu, Badege Bishaw, and Emiru Hizikias			Austin/Parrish Boardroom
<i>Adoption, Implementation, and Evaluation</i>	Speaker: Mick O'Neill <a href="#">Title: New Agroforestry Working Group in the American Southwest</a>	Speaker: Jono Neiger <a href="#">Title: Chestnut Agroforestry in New England: Regional Initiative, Case Studies, and Gap Analysis</a>	Speaker: Tom Sauer <a href="#">Title: Possibilities: The map that guided the audacious 1930's Prairie States Forestry Project</a>	Johnson Lounge
<b>10:45–11:00am</b>	<b>Break</b>			
<b>11:00am–12:00pm</b>	<b>Concurrent Session 2</b>			
<b>Track</b>	<b>Speaker 1 – 11:00-11:20</b>	<b>Speaker 2 – 11:20-11:40</b>	<b>Speaker 3 – 11:40-12:00</b>	<b>Room</b>
<i>Accessing Resources, Accessing Markets, and Managing Risk</i>	Speaker: Sophie Mendelson <a href="#">Title: Leveraging terroir in North American agroforestry foodways</a>	Speaker: Dean Current <a href="#">Title: Energy Bars, Beer and Super Foods: A method for, and case of, exploring markets for a non-timber forest product</a>	Speaker: Lila Karki <a href="#">Title: Woodland Grazing for Minimizing the Costs of Raising Small Ruminants in the Southeast</a>	Willamette Room 115
<i>Advances in Technology Applications</i>	Speaker: Todd Kellerman <a href="#">Title: Mapping tree resources in the Great Plains using high-resolution imagery</a>	Speaker: Phillip Ray Owens <a href="#">Title: Digital soil mapping to predict management zones for forage and tree production</a>	Speaker: Nuria Ferreiro Domínguez <a href="#">Title: Recommendations for policy makers in light of climate change: AFINET</a>	Trysting Tree Room 114
<i>Environmental Benefits</i>	Speaker: Colin Mitchell <a href="#">Title: Agroforestry Pathways to Enhanced Ecosystem Services &amp; Producer Payments for a Healthier Environment</a>	Speaker: Maayan Kreitzman <a href="#">Title: Environmental and Food Production Outcomes of Woody Perennial Polycultures in the US Midwest</a>		Elle/Burlingham Room 111

<i>Specialty Forest Products</i>	Panel Discussion <a href="#">Title: What do we know about specialty forest products? Lessons from the Assessment of nontimber forest products in the United States under Changing Conditions</a> Marla Emery, Susan Alexander, Frank Lake, and Gregory Ormsby Mori			Cascade Ballroom
<i>Climate Change</i>	Demonstration <a href="#">Title: FoodPlaces: A platform for creating productive landscapes in public and civic spaces</a> Mario Yanez			Austin/Parrish Boardroom
<i>Adoption, Implementation, and Evaluation</i>	Speaker: Adam Beck <a href="#">Title: Projecting agroforestry nutrient trading in Virginia, U.S.A. using landowner surveys and BayFAST models</a>	Speaker: Kate MacFarland <a href="#">Title: Multi-party arrangements: innovative land and capital partnerships for agroforestry</a>	Speaker: Sarah Taylor Lovell <a href="#">Title: A Landscape Level Perspective for Agroforestry Planning</a>	Johnson Lounge
<b>12:00–1:15pm</b>	<b>Awards Luncheon</b>			Cascade Ballroom
<b>1:15pm–2:15pm</b>	<b>Concurrent Session 3</b>			
<b>Track</b>	<b>Speaker 1 – 1:15-1:35</b>	<b>Speaker 2 – 1:35-1:55</b>	<b>Speaker 3 – 1:55-2:15</b>	<b>Room</b>
<i>Accessing Resources, Accessing Markets, and Managing Risk</i>	Panel Discussion <a href="#">Title: USDA Resources for Agroforestry Research</a> Kate MacFarland, Sarah Taylor Lovell, John Fike, and Nicholas Andrews Moderated by Matthew Smith			Willamette Room 115
<i>Advances in Technology Applications</i>	Speaker: Adolfo Rosati <a href="#">Title: Agroforestry models overestimate photosynthesis of understory crops</a>	Speaker: Kevin Wolz <a href="#">Title: Calibration of the 3D Hi-sAFe agroforestry model for hybrid walnut</a>	Speaker: Chad W Higgins <a href="#">Title: Potential for agrivoltaics and an 'energy canopy'</a>	Trysting Tree Room 114
<i>Environmental Benefits</i>	Speaker: Tom Sauer <a href="#">Title: Effect of red cedar windbreaks on soil physical properties in the U.S. Great Plains</a>	Speaker: Laura Poppy <a href="#">Title: Field Boundary Habitats - Their Role in the Health &amp; Productivity of the Agro-Ecosystem</a>		Elle/Burlingham Room 111
<i>Specialty Forest Products</i>	Speaker: Tiffany Hopkins <a href="#">Title: Pacific Northwest NTFP Production and how a local woodland coop is helping producers break through market barriers</a>	Speaker: Katie Commender <a href="#">Title: The Appalachian Harvest Herb Hub - Successes and Challenges</a>	Speaker: Eric Burkhart <a href="#">Title: Neither wild nor cultivated: American ginseng (<i>Panax quinquefolius L.</i>) trade surveys in Pennsylvania, U.S.A., provide insights into husbandry of an internationally traded non-timber forest product</a>	Cascade Ballroom

<i>Adoption, Implementation, and Evaluation</i>	Speaker: Dean Current <a href="#">Title: Determining landowner knowledge, attitudes and practices related to adoption of snow control measures</a>	Speaker: Andy Perleberg <a href="#">Title: 15-Year Survival and Growth Review of the Davenport Living Snow Fence Demonstration in Washington State</a>		Johnson Lounge
<b>2:15–2:30pm</b>	<b>Coffee Break</b>			Foyer
<b>2:30–3:30pm</b>	<b>Concurrent Session 4</b>			
<b>Track</b>	<b>Speaker 1 – 2:30-2:50</b>	<b>Speaker 2 – 2:50-3:10</b>	<b>Speaker 3 – 3:10-3:30</b>	<b>Room</b>
<i>Accessing Resources, Accessing Markets, and Managing Risk</i>	Panel Discussion <a href="#">Title: Agroforestry costs and benefits: Information sharing and collaboration</a> Sarah Taylor Lovell, Kevin Wolz, Tracey Coulter, John Hendrickson Moderated by Gary Bentrup			Willamette Room 115
<i>Advances in Technology Applications</i>	Speaker: Alonso Ulloa Leitón <a href="#">Title: Analysis of the structure, morphology and chemical composition of the prickly pear spine to determine its potential uses</a>	Speaker: Khanh-Van Ho <a href="#">Title: Anti-inflammatory properties of black walnut (<i>Juqlans nigra</i>) extracts in human pro-monocytic cell line U-937</a>	Speaker: Rosa Garcia-Nuñez <a href="#">Title: Trees and Shrubs of Multiple Uses in the Southeast of Guanajuato: Mezquites and Huizaches</a>	Trysting Tree Room 114
<i>Education, Outreach, and Community Engagement</i>	Speaker: Mike Gold <a href="#">Title: Tracing 35 Years of Agroforestry Development in the USA: Past, Present, Future</a>	Speaker: Adolfo Rosati <a href="#">Title: Updates from the European Agroforestry Federation (EURAF)</a>		Elle/ Burlingham Room 111
<i>Specialty Forest Products</i>	Speaker: Andy Perleberg <a href="#">Title: Dangers you ought to be aware of while working in the forest</a>	Speaker: Gary Wyatt <a href="#">Title: Food Forests - Building Edible Community Landscapes</a>	Speaker: Patrick Shults <a href="#">Title: Evaluating Commercial Specialty Mushroom Production for Diversified Farms and Small Woodland Owners in Western WA</a>	Cascade Ballroom
<i>Adoption, Implementation, and Evaluation</i>	Speaker: Rowan Reid <a href="#">Title: 25 years on: Australian farmers validate an alternative model for agroforestry development</a>	Speaker: Sonia Bruck <a href="#">Title: Results of the Pre-Test Assessing Adoption of Agroforestry in West Tanzania</a>	Speaker: María Edna Álvarez Sánchez <a href="#">Title: Integrative Agroforestry in a Community of the Sierra Madre Oriental</a>	Johnson Lounge
<b>3:30–3:45pm</b>	<b>Break</b>			

3:45–4:45pm		Concurrent Session 5		
Track	Speaker 1 – 3:45-4:05	Speaker 2 – 4:05-4:25	Speaker 3 – 4:25-4:45	Room
<i>Accessing Resources, Accessing Markets, and Managing Risk</i>	Speaker: Caroline Simard <a href="#">Title: Private and societal values of agroforestry systems in southern Quebec: how to enhance voluntary adoption?</a>	Speaker: Susan Stein <a href="#">Title: Opportunities and Recommendations for Enhancing Agroforestry Economics</a>		Willamette Room 115
<i>Production Science</i>	Speaker: Gregory Ormsby Mori <a href="#">Title: Agroforestry Specialty Crop Development for the Midwest</a>	Speaker: James Allen <a href="#">Title: Food Forests in Cities and Smaller Communities of the American Southwest</a>	Speaker: Shailes Bhattraï <a href="#">Title: Vegetation Height and Diurnal Period Influenced the Behaviors and Distribution Patterns of Small Ruminants in Woodlands During Fall</a>	Trysting Tree Room 114
<i>Education, Outreach, and Community Engagement</i>	Speaker: Mark Kopecky <a href="#">Title: Stimulating interest in silvopasture among farmer-members of an organic farm marketing cooperative</a>	Speaker: Jerome Osentowski <a href="#">Title: Indoor and Outdoor Forest Farming for Year-Round Food and Medicine Production, Carbon Sequestration, Soil-Building, and Climate Change Mitigation</a>		Elle/ Burlingham Room 111
<i>Specialty Forest Products</i>	Speaker: David Doty <a href="#">Title: Case Study of Forest Grown Ginseng, as told by United Plant Savers and Mountain Rose Herbs</a>	Speaker: Teal Jordan <a href="#">Title: Phytochemical Changes in Ramps (<i>Allium tricoccum</i>) Across Seasonal and Reproductive Development</a>	Speaker: Eric Burkhart <a href="#">Title: Agroforestry and forest herbs: the effect of harvest time and forest site on alkaloid content in forest grown goldenseal (<i>Hydrastis canadensis</i> L.)</a>	Cascade Ballroom Room 110
<i>Climate Change</i>	Speaker: Steve Gabriel <a href="#">Title: Tree Fodders: Silvopasture for a Changing Climate</a>	Speaker: Ryan Dibala <a href="#">Title: Initial Performance of Red Mulberry (<i>Morus rubra</i>) Along a Shade Gradient: An Overlooked Supplemental Livestock Forage?</a>	Speaker: Nicolas Goncalves <a href="#">Title: Carbon Sequestration and its Potential Economic Impact in Coffee Agroforestry Systems in Sao Paulo, Brazil</a>	Austin/ Parrish Boardroom
<i>Adoption, Implementation, and Evaluation</i>	Panel Discussion <a href="#">Title: Advancing Agroforestry through the Private Sector: Agroforestry Consultants and Beyond</a> Shane Hetzler, Jude Hobbs, Connor Stedman, and Ethan Steinberg Moderated by Kate MacFarland			Johnson Lounge
<b>4:45-5:30pm</b>	<b>All-Hands AFTA Business Meeting (all are welcome)</b>			Cascade Ballroom
<b>5:00-7:00pm</b>	<b>Poster Presentation and Reception</b>			Alumni Center
<b>7:00 pm</b>	<b>Dinner On Your Own</b>			Downtown Corvallis

THURSDAY, JUNE 27

7:30–8:30am	<b>Continental Breakfast</b>			Cascade Ballroom
8:30–9:15am	<b>Keynote: “The art and science of growing trees on farms for conservation and profit”</b> Rowan Reid, Forest Scientist and Tree Grower, Bamba Agroforestry Farm			Cascade Ballroom
9:15–9:30am	<b>Coffee Break</b>			Foyer
9:30–10:30am	<a href="#">Concurrent Sessions 6</a>			
<b>Track</b>	<b>Speaker 1 – 9:30-9:50</b>	<b>Speaker 2 – 9:50-10:10</b>	<b>Speaker 3 – 10:10-10:30</b>	<b>Room</b>
<i>Accessing Resources, Accessing Markets, and Managing Risk</i>	Panel Discussion <a href="#">Title: Land access for agroforestry: examples and case studies</a> Katie Commender, Erik Hagan, and Kevin Wolz Moderated by Kate MacFarland			Willamette Room 115
<i>Production Science</i>	Speaker: Uma Karki <a href="#">Title: Southern Pines Performed Better in Silvopastures than in Woodland Grazing System</a>	Speaker: Gary Wyatt <a href="#">Title: Vegetative Windbreaks for Poultry Farms</a>	Speaker: Matt Dami <a href="#">Title: Syntropy in Practice: Managing Succession Dynamics to Produce Quality Food, Draw Down Carbon, and Generate Sustainable Livelihoods</a>	Trysting Tree Room 114
<i>Adoption, Implementation, and Evaluation</i>	Speaker: Diomy Zamora <a href="#">Title: Silvopasture as an approach to restoring productivity of unmanaged woodland grazing in Minnesota</a>	Speaker: Diane Mayerfeld <a href="#">Title: Animal welfare benefits and production challenges in silvopasture</a>	Speaker: Philadelphia Wilkens <a href="#">Title: How and why might livestock producers in Virginia, U.S.A. adopt silvopasture?</a>	Elle/ Burlingham Room 111
<i>Policy in Practice</i>	Speaker: Sarah Coffey <a href="#">Title: Edible Green Infrastructure in the Mid-Atlantic: Policy Approaches and Drivers at the Municipal Level</a>	Speaker: Colleen Rossier <a href="#">Title: How can integrating Western and Indigenous agroforestry science, and practice, and management enhance both ecological and socio-ecological resilience?</a>		Cascade Ballroom
<i>Climate Change</i>	Panel Discussion <a href="#">Title: Agroforestry Plant Materials for a Changing Climate</a> Sonja Brodt, Mike Gold, Matt Smith, and Ron Revord Moderated by Gary Bentrup			Austin/ Parrish Boardroom
10:30–10:45am	<b>Break</b>			

10:45–11:45am	Concurrent Sessions 7																	
Track	Speaker 1 – 10:45-11:05	Speaker 2 – 11:05-11:25	Speaker 3 – 11:25-11:45	Room														
<i>Accessing Resources, Accessing Markets, and Managing Risk</i>	Panel Discussion <a href="#">Title: Public Private Partnerships in developing Cooperative Marketing Opportunities for Enhancing Chestnut (<i>Castanea spp.</i>) Production and Conservation: A Pennsylvania example.</a> Erik Hagan, Tracey Coulter, and Kate MacFarland			Willamette Room 115														
<i>Production Science</i>	Speaker: Alan Franzluebbers <a href="#">Title: Silvopasture production characteristics in the Coastal Plain of North Carolina</a>	Speaker: Mounir Louhaichi <a href="#">Title: Silvopastoral Systems and Climate Change Mitigation in Central Tunisia</a>		Trysting Tree Room 114														
<i>Education, Outreach, and Community Engagement</i>	Roundtable Discussion <a href="#">Title: Indigenous Partnerships for Agroforestry: Initiating a Decolonized Process</a> Frank Lake, Colleen Rossier, and Rowen White. Facilitated by Hannah Hemmelgarn			Elle/ Burlingham Room 111														
<i>Policy in Practice</i>	Speaker: Sarah Brown <a href="#">Title: A systematic map of evidence on the impacts of agroforestry interventions in temperate countries</a>	Speaker: Gregory Ormsby Mori <a href="#">Title: Agroforestry policy development in the USA</a>	Speaker: Rico Hübner <a href="#">Title: The agroforestry governance nexus: an exploratory assessment in Germany and Europe</a>	Cascade Ballroom														
<i>Adoption, Implementation, and Evaluation</i>	Roundtable Discussion <a href="#">Title: Silvopasture: How can we get farmers to plant more trees?</a> Facilitated by Steve Gabriel			Johnson Lounge														
<b>11:45am-12:00pm</b>	<b>Closing Remarks</b> – Badege Bishaw, Program Chair <b>Graduate Student presentation winners announced</b>			Cascade Ballroom														
<b>12:00pm-1:00pm</b>	<b>Lunch (on your own)</b> Dining options include Memorial Union and Arnold Dining Hall (see map)																	
<b>1:00pm</b>	<b>Working Groups and Regional Meetings (open to all)</b> Starting with a brief plenary session sharing perspectives on working at a regional scale, join others in your region to learn who else is involved with agroforestry and discuss opportunities, challenges, projects, and partnerships in your area.  <table border="0"> <tr> <td><b>Regional Meetings</b></td> <td><b>Group Meetings</b></td> </tr> <tr> <td>Northeast/Mid-Atlantic</td> <td>American Forest Farming Council</td> </tr> <tr> <td>Southeast</td> <td>USDA Agricultural Research Service</td> </tr> <tr> <td>Midwest</td> <td></td> </tr> <tr> <td>Great Plains</td> <td></td> </tr> <tr> <td>Pacific Northwest</td> <td></td> </tr> <tr> <td>Southwest</td> <td></td> </tr> </table>			<b>Regional Meetings</b>	<b>Group Meetings</b>	Northeast/Mid-Atlantic	American Forest Farming Council	Southeast	USDA Agricultural Research Service	Midwest		Great Plains		Pacific Northwest		Southwest		Cascade Ballroom
<b>Regional Meetings</b>	<b>Group Meetings</b>																	
Northeast/Mid-Atlantic	American Forest Farming Council																	
Southeast	USDA Agricultural Research Service																	
Midwest																		
Great Plains																		
Pacific Northwest																		
Southwest																		

## Poster Presentations

Álvarez Sánchez, María Edna	<a href="#">Nutritional assessment of <i>Moringa oleifera</i> Lam plantations to optimize oil production</a>
Bentrup, Gary	<a href="#">Tree Advisor: Selecting Woody Plants for Agroforestry in the Great Plains</a>
Brodth, Sonja	<a href="#">Assessing elderberry hedgerows for commercial production in California</a>
Buendía-Espinoza, Julio Cesar*	<a href="#">Physical and Sensorial Quality of Coffee (<i>Coffea arabica</i> L.) in Coatepec, Veracruz, Mexico</a>
Cahuich Damián, Jesus*	<a href="#">Shrubs and herbaceous plants in ecological rehabilitation processes in a semi-dry climate</a>
Coleman, Brent*	<a href="#">Carbon sequestration in riparian buffer systems as influenced by soil texture, vegetation type and age in Ontario, Canada</a>
Current, Dean	<a href="#">Farmmaps - A farmer to farmer database and networking tool</a>
Dold, Christian	<a href="#">Impact of tree windbreaks on annual crops - carbon uptake and water use</a>
Domínguez, Nuria Ferreiro	<a href="#">Agroforestry Policy in Europe</a>
Dwikarina, Amanda*	<a href="#">Characterization of the anti-tumor taccalonolides isolated from black bat flower (<i>Tacca chantrieri</i>) in Indonesia</a>
Efrat, Novianus*	<a href="#">Switchgrass (<i>Panicum virgatum</i>) bioactive compounds profiling through untargeted and targeted analysis</a>
Emery, Marla	<a href="#">Nontimber Forest Products in the United States</a>
Fike, John	<a href="#">Forage and Heifer Responses to Silvopasture Management</a>
Garza-Lau, Ruben*	<a href="#">Nutritional Input From Nitrogen Fixing Tree Species To A Coffee Agroforestry System</a>
García Núñez, Rosa María	<a href="#">Bird diversity in two Agroforestry systems and a Mountain Cloud Tropical Forest</a>
Ho, Khanh-Van*	<a href="#">Identifying Antibacterial Compounds in Black Walnuts (<i>Juqans nigra</i>) Using A Metabolomics Approach</a>
Hsu, Shuyu*	<a href="#">A Bacillus Thuringiensis Spore Expression System for Bioremediation</a>
Kellerman, Todd	<a href="#">Agroforestry Inventory: Translating Research to Landowners</a>
Louhaichi, Mounir	<a href="#">Community Participation Towards Silvopastoral Restoration</a>
Maldonado, Ranferi	<a href="#">Nutrition for rapid growth of mahogany plants (<i>Swietenia macrophylla</i> King)</a>
Maldonado, Ranferi	<a href="#">Contribution to the study of the agro forest entomology system of the <i>Lippia myriocephala</i> tree as a source of fuel and means of reproduction of the larva <i>Phassus triangularis</i></a>
Mendelson, Sophie*	<a href="#">The Agroforestry Academy - Impacts on Adoption</a>
Merwin, Miles	<a href="#">Cooperative Marketing of Special Forest Products in Oregon</a>
Mosquera Losada, María Rosa	<a href="#">Silvoarable practices as a mechanism to enhance climate adaptation</a>
Ofosu, Enoch*	<a href="#">Carbon sequestration potentials of diverse riparian buffer systems in Southern Ontario</a>
Penkauskas, Calvin*	<a href="#">Resolving conflict between oak conservation and organic hazelnut production</a>
Poudel, Sanjok*	<a href="#">Performance of Katahdin Rams in Southern-pine Silvopasture and Woodland Grazing Systems</a>
Pudota, Mounika*	<a href="#">Agroforestry Alley Cropping with Specialty Crops among Loblolly Pine and Pecan Stands.</a>
Pugh, Brahmi	<a href="#">The governance of agroforestry in the United States: Virginia and Missouri</a>
Valencia Trejo, Guadalupe Montserrat*	<a href="#">Community Territorial Planning with an Agroforestry Approach in Xaltepuxtla, Puebla, Mexico</a>
Vo, Phuc*	<a href="#">Quantification of Bioactive Phytochemicals in Spent Coffee Grounds by Liquid Chromatography Tandem-mass Spectrometry (LC-MS/MS)</a>
Zamora, Diomy	<a href="#">Bioenergy Production and Soil Health Potentials of Eastern Red Cedar Windbreaks in the U.S. Great Plains</a>

\* student presentation



# CH2M Hill Alumni Center

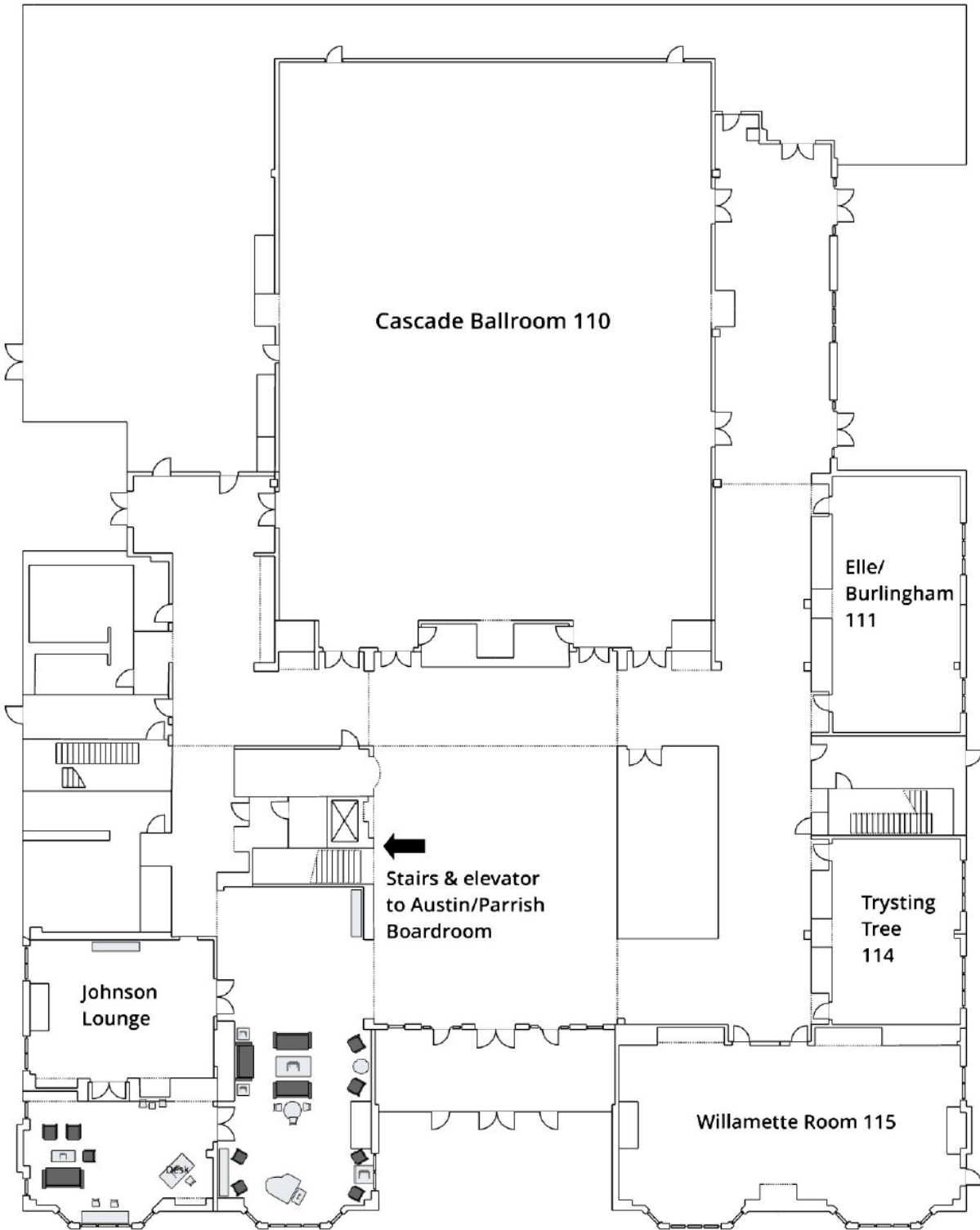

10 Feet

# Oregon State University Campus Map

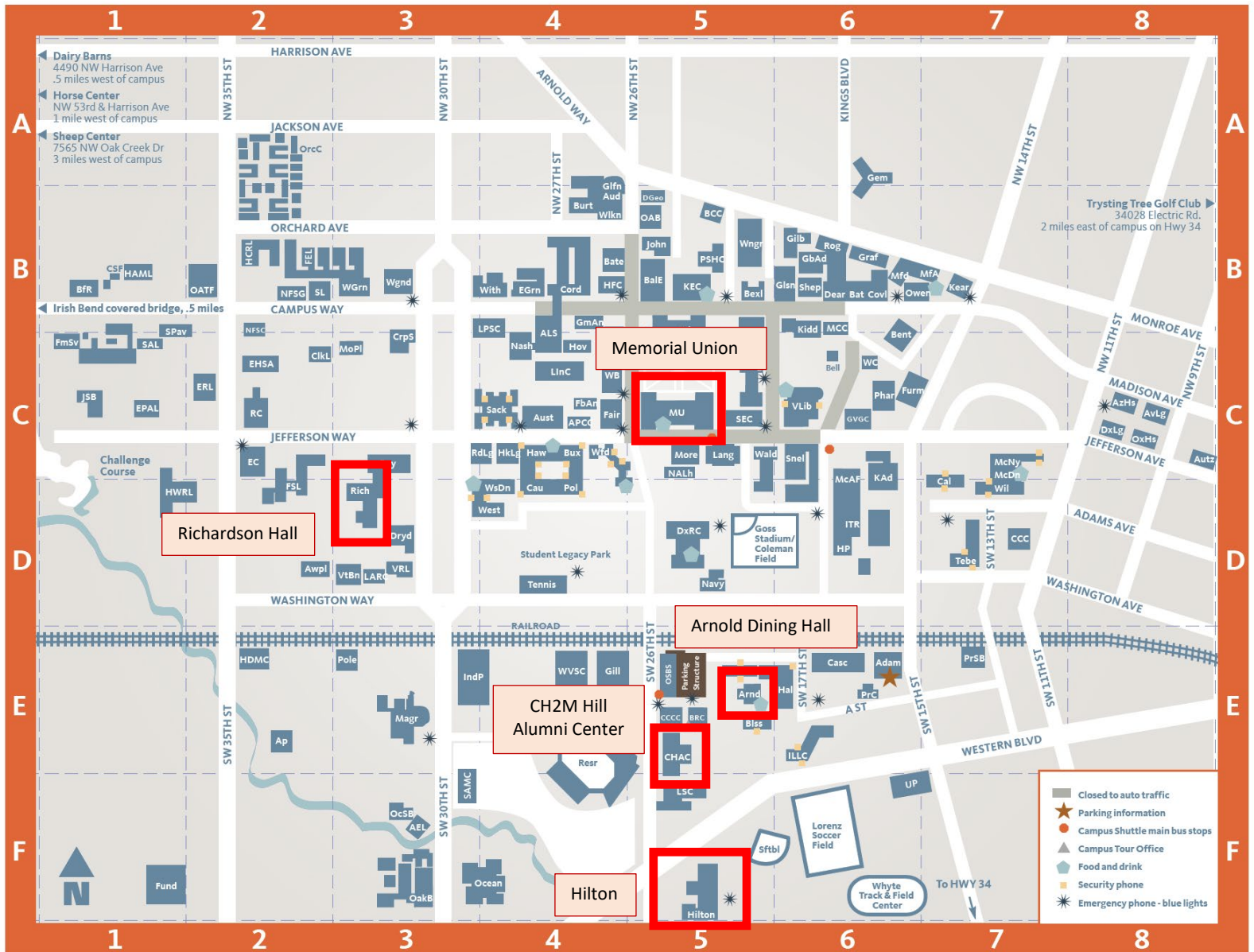

# Oregon State University Campus Map Key

Adams Hall..... Adam..... E6	Dawes House..... DGeo..... B5	Hogg Animal	Nash Hall..... Nash..... C4	Shepard Hall..... Shep..... B6
Advanced Wood	Dearborn Hall..... Dear..... B6	Metabolism Lab..... HAML..... B1	National Forage	Small Animal Lab..... SAL..... C1
Products Lab..... Awpl..... D2	Dixon Lodge..... DxLg..... C8	Horticulture Crops	Seed Research Center..... NFSC..... B2	Snell Hall..... Snel..... C6
Aero Engineering Lab..... AEL..... F3	Dixon Recreation Center..... DxRC..... D5	Research Lab..... HRCL..... B2	Native American	Softball Complex..... Sftbl..... F5
Agricultural and Life	Dryden Hall..... Dryd..... D3	Hovland Hall..... Hov..... C4	Longhouse, Eena Haws..... NALH..... C5	Stevens Natatorium..... DxRC..... D5
Sciences Building..... ALS..... B4	Energy Center..... EC..... C2	Indoor Target Range..... ITR..... D6	Naval ROTC Armory..... Navy..... D5	Stock Judging Pavilion..... SPav..... B1
Apiary Complex..... Ap..... E2	Environmental Health	International Living-	Oak Creek Building..... OakB..... F3	Strand Agriculture Hall..... StAg..... C5
Arnold Dining Center..... Arnd..... E5	and Safety Annex..... EHSA..... C2	Learning Center..... ILLC..... E6	Ocean Administration	Student Experience Center... SEC..... C5
Asian and Pacific	EPA Environmental	Jefferson Street Building..... JSB..... C1	Building..... OAB..... B5	Student Legacy Park..... D4
Cultural Center..... APCC..... C4	Research Lab..... ERL..... C2	Johnson Hall..... John..... B5	Oceanography Complex..... Ocean..... F4	Tebeau Hall..... Tebe..... D7
Austin Hall..... Aust..... C4	EPA Laboratory..... EPAL..... C1	Kearney Hall..... Kear..... B7	Oceanography Staging..... OCSB..... F3	Tennis Complex..... Tennis..... D4
Autzen House..... Autz..... C8	Fairbanks Annex..... FbAn..... C4	Kelley Engineering Center .... KEC..... B5	Oldfield Animal	Transit Services..... Adam..... E6
Avery Lodge..... AvLg..... C8	Fairbanks Hall..... Fair..... C4	Kerr Administration BuildingKAD..... C6	Teaching Facility..... OATF..... B2	UHDS Maintenance Center .. HDMC..... E2
Azalea House..... AzHs..... C8	Farm Services..... FmSv..... C1	Kidder Hall..... Kidd..... B6	Orchard Court Apartments .. Orc..... B2	University Plaza..... UP..... F6
Ballard Extension Hall..... BalE..... B5	Finley Hall..... Finl..... E5	Laboratory Animal	OSU Beaver Store..... OSBS..... E5	Valley Football Center..... VFbC..... E4
Batcheller Hall..... Bat..... B6	Forest Sciences Lab..... FSL..... D2	Resource Center..... LARC..... D3	OSU Foundation Center..... Fund..... F1	Valley Library..... VLib..... C6
Bates Hall..... Bate..... B4	Furman Hall..... Furm..... C6	Langton Hall..... Lang..... C5	Owen Hall..... Owen..... B6	Veterinary Dairy Barn..... VtBn..... D3
Beef Research..... BfR..... B1	The Gem..... Gem..... B6	The LaSells Stewart Center... LSC..... F5	Oxford House..... OxHs..... C8	Veterinary Horse Barn..... Pole..... E2
Bell Tower..... Bell..... C6	Gilbert Addition..... GbAd..... B6	Learning Innovation Center.. LInC..... C4	P. Wayne Valley Sports	Veterinary Research Lab..... VRL..... D3
Benton Hall..... Bent..... C6	Gilbert Hall..... Gilb..... B6	Linus Pauling	Performance Center..... WVSC..... E4	Waldo Hall..... Wald..... C5
Beth Ray Center	Gilfillan Auditorium..... Gilfn Aud B4	Science Center..... LPSC..... B3	Parking Services..... Adam..... E6	Weatherford Hall..... Wfd..... C4
for Academic Support..... BRC..... E5	Gilkey Hall..... GilK..... C5	Lorenz Soccer Field..... F6	Parking Structure..... E5	Welcome Center..... BRC..... E5
Bexell Hall..... Bexl..... B5	Gill Coliseum..... Gill..... E4	Lonnie B. Harris	Peavy Hall..... Pvy..... D3	Weniger Hall..... Wngr..... B5
Bloss Hall..... Blss..... E5	Gilmore Annex..... GmAn..... B4	Black Cultural Center..... BCC..... B5	Pharmacy Building..... Phar..... C6	Whyte Track and Field Center..... F6
Burt Hall..... Burt..... B4	Gilmore Hall..... Gilm..... B4	Magruder Hall..... Magr..... E3	Plageman Student	Wiegand Hall..... Wgnd..... B3
Buxton Hall..... Bux..... C4	Gladys Valley	Marketplace	Health Center..... PSHC..... B5	Wilkinson Hall..... Wlkn..... B4
Callahan Hall..... Cal..... C7	Gymnastics Center..... GVGC..... C6	West Dining Center..... WsDn..... D4	Pole Building..... Pole..... E3	Wilson Hall..... Wil..... D7
Cascade Hall..... Casc..... E6	Gleeson Hall..... GlSn..... B6	McAlexander Field House .... McAF..... C6	Poling Hall..... Pol..... D4	Withycombe Hall..... With..... B4
Cauthorn Hall..... Cau..... D4	Goss Stadium..... Goss..... D6	McNary Dining Center..... McDn..... C7	Pride Center..... PrC..... E6	Women's Building..... WB..... C4
Central Receiving	Graf Hall..... Graf..... B6	McNary Hall..... McNy..... C7	Public Safety..... Casc..... E6	Women's Center
and Delivery..... PrSB..... E7	Greenhouse East..... EGrn..... B4	Memorial Union..... MU..... C5	Purchasing..... PrSB..... E7	(Benton Annex)..... WC..... C6
Centro Cultural	Greenhouse West..... WGrn..... B3	Merritt Truax	Radiation Center..... RC..... C2	
César Chávez..... CCCC..... E5	Hallie Ford Center..... HFC..... B4	Indoor Practice Facility..... IndP..... E3	Reed Lodge..... RdLg..... C4	
CH2M HILL Alumni Center... CHAC..... E5	Halsell Hall..... Hal..... E6	Merryfield Annex..... MfA..... B7	Reser Stadium..... Resr..... E4	
Child Care Center..... CCC..... D7	Hawley Hall..... Haw..... C4	Merryfield Hall..... Mfd..... B6	Richardson Hall..... Rich..... D3	
Clark Laboratory..... ClkL..... C2	Heating Plant..... HP..... D6	Milam Auditorium..... MAU..... C5	Rogers Hall..... Rog..... B6	
Climbing Center..... DxRC..... D5	Heckart Lodge..... HkLg..... C4	Milam Hall..... Mlm..... B5	Sackett Hall..... Sack..... C4	
Coleman Field..... D6	Hilton Garden Inn..... Hilton..... F5	Milne Computer Center..... MCC..... B6	Samaritan Sports	
Commodity Storage Facility .CSF..... B1	Hinsdale Wave	Moreland Hall..... More..... C5	Medical Center..... SSMC..... E3	
Cordley Hall..... Cord..... B4	Research Lab..... HWRL..... D1	Motor Pool..... MoPl..... C3	Seed Lab..... SL..... B2	
Covell Hall..... Covl..... B6				
Crop Science Building..... CrpS..... C3				

